

BW CABLE GLAND (2 PART)

We are engaged in offering BW Cable Gland (2 PART) which is in line with BS 6346 (1969) standards. Available in GEL (cast integral earth lug), these are used with armour or braided cable. Further, this secure armoring & provides electrical continuity between armour & gland entry component that are used for dry and indoor condition.

Design Features : 2 part armour lack, Knurled armor lack produces a low resistance earth clip.

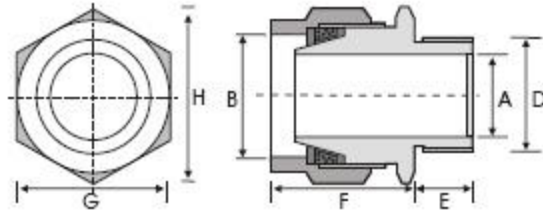

BW Cable Gland (2 Part)

Application : For use with armour or braided cable, secures armoring & provides electrical continuity between armour & gland entry component made used it dry and indoor condition

Design Features : 2 part armour lack, Knurled armour lack produces a low resistance earth clip.

Also available in GEL (cast integral earth lug), for orders add " C" to prod. code

Product Specification

Size	Cable Dimensions Accommodate			Gland Dimensions					Prod. Code
	Under Armour Dia A Max.	Overall Dia. B Max.	Armour wire dia C	ISO Entry Thread		Approx length from shoulder	Hexagon Size		
	mm	mm	mm	Dia	Length		Across flat	Across corners	
				D mm	E mm	F mm	G mm	H mm	
16	8.6	13.5	0.9	16	10	23	20	23	HBW 16
20 S	12.3	17	0.90/1.25	20	10	23	23	24	HBW 20 S
20	14.3	20	0.90/1.25	20	10	30	25	27	HBW 20
25 S	18	23.8	1.25/1.60	25	10	30	31	32.5	HBW 25 S
25	20.4	27	1.25/1.60	25	10	32	30	38.5	HBW 25
32	26.5	33	1.60/2.00	32	10	36	41.5	45.5	HBW 32
40 S	31	37	1.60/2.00	40	10	36	45	50	HBW 40S
40	32.5	43	1.60/2.00	40	15	40	49	54	HBW 40
50S	37.8	48	2.00/2.50	50	15	40	58	65	HBW 50S
50	44	53	2.00/2.50	50	15	45	62.3	69.5	HBW 50
63S	50.5	60.5	2.5	63	15	45	70	77	HBW 63S
63	56.5	65.5	2.5	63	15	50	76.3	85	HBW 63
75S	62.5	72	2.5	75	15	50	85	95	HBW 75 S
75	67.5	78.5	2.50/3.15	75	15	75	90.5	99	HBW 75
90	80	93	3.15	90	20	75	112	125	HBW 90



[Home](#) | [Profile](#) | [Quality](#) | [Achievements](#) | [Gallery](#) | [Contact](#) | [Enquiry](#)



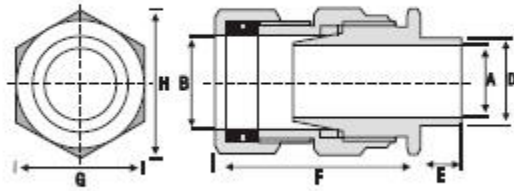

CW Gland (4 Part)

Similar in application and design to the cw (3 part) gland. However an extra component is added, a cone ring. This prevents rotation of the wire and is used instead of a knurled cone.

Product Specification

Size	Cable Dimensions Accommodate			Gland Dimensions					Prod. Code
	Under Armour Dia A Max.	Overall Dia. B Max.	Armour wire dia C	ISO Entry Thread		Approx length from shoulder	Hexagon Size		
	mm	mm	mm	Dia	Length		Across flat	Across corners	
				D mm	E mm	F mm	G mm	H mm	
16	8.6	13.50	0.90	16	10	40.00	20.00	23.00	HCW 16
20 S	12.50	17.00	0.90 / 1.25	20	10	47.00	22.00	29.00	HCW 20 S
20	14.40	20.50	0.90 / 1.25	20	10	47.00	26.00	29.00	HCW 20
25 S	17.80	23.80	1.25 / 1.60	25	10	50.00	31	34.00	HCW 25 S
25	20.40	27.00	1.25 / 1.60	25	10	50.00	34.00	38.50	HCW 25
32	26.50	33.00	1.60 / 2.00	32	10	55.00	41.50	46.50	HCW 32
40 S	31.00	37.00	1.60 / 2.00	40	10	60.00	45.00	50.00	HCW 40 S
40	32.50	40.80	1.60/2.00	40	15	60.00	49.00	54.00	HCW 40
50S	37.80	45.00	2.00 / 2.50	50	15	65.00	51.00	64.00	HCW 50 S
50	44.00	51.50	2.00 / 2.50	50	15	65.00	62.30	69.50	HCW 50
63S	50.50	60.50	2.50	63	15	70.00	70.00	78.00	HCW 63 S
63	56.50	65.50	2.50	63	15	70.00	76.30	85.00	HCW 63
75S	62.50	72.00	2.50	75	15	75.00	85.00	95.00	HCW 75 S
75	67.50	78.50	2.50 / 3.15	75	15	75.00	91.00	112.00	HCW 75
90	80.00	90.00	3.15	90	20	90.00	103.00	115.00	HCW 90