

AIO SOLAR

6M 90W Solarstreetlight AIO-SST-02 Singlehead

Work Principle

The solar energy is converted into electricity stored in the battery by the solar panel through the day time, The solar panel voltage will decrease gradually in the dark time. When the solar panel voltage is lower than stipulated voltage, the controller will make the battery supply electricity to load; When the day become bright, the solar panel voltage increase gradually. After the voltage is larger than stipulated voltage, the controller will stop the battery supplying the electricity to load. This is working principle of solar street light.

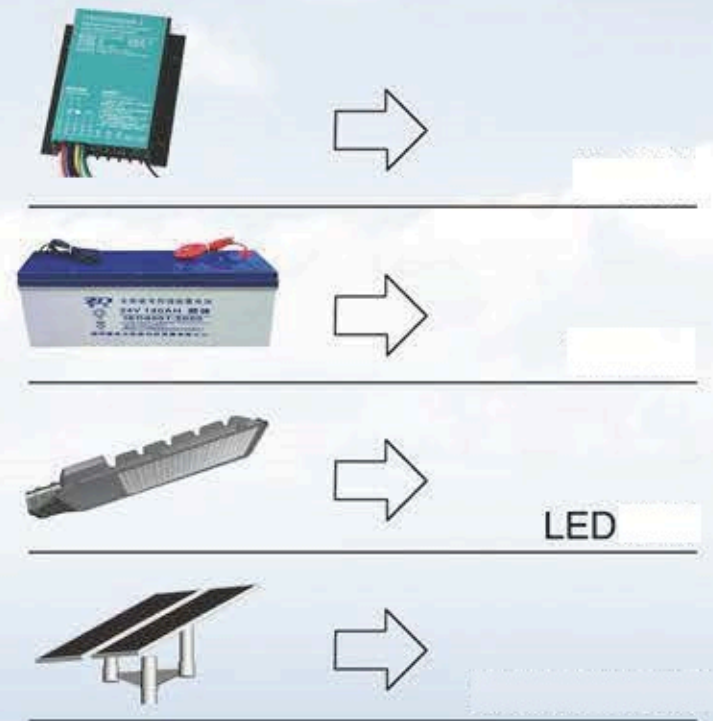
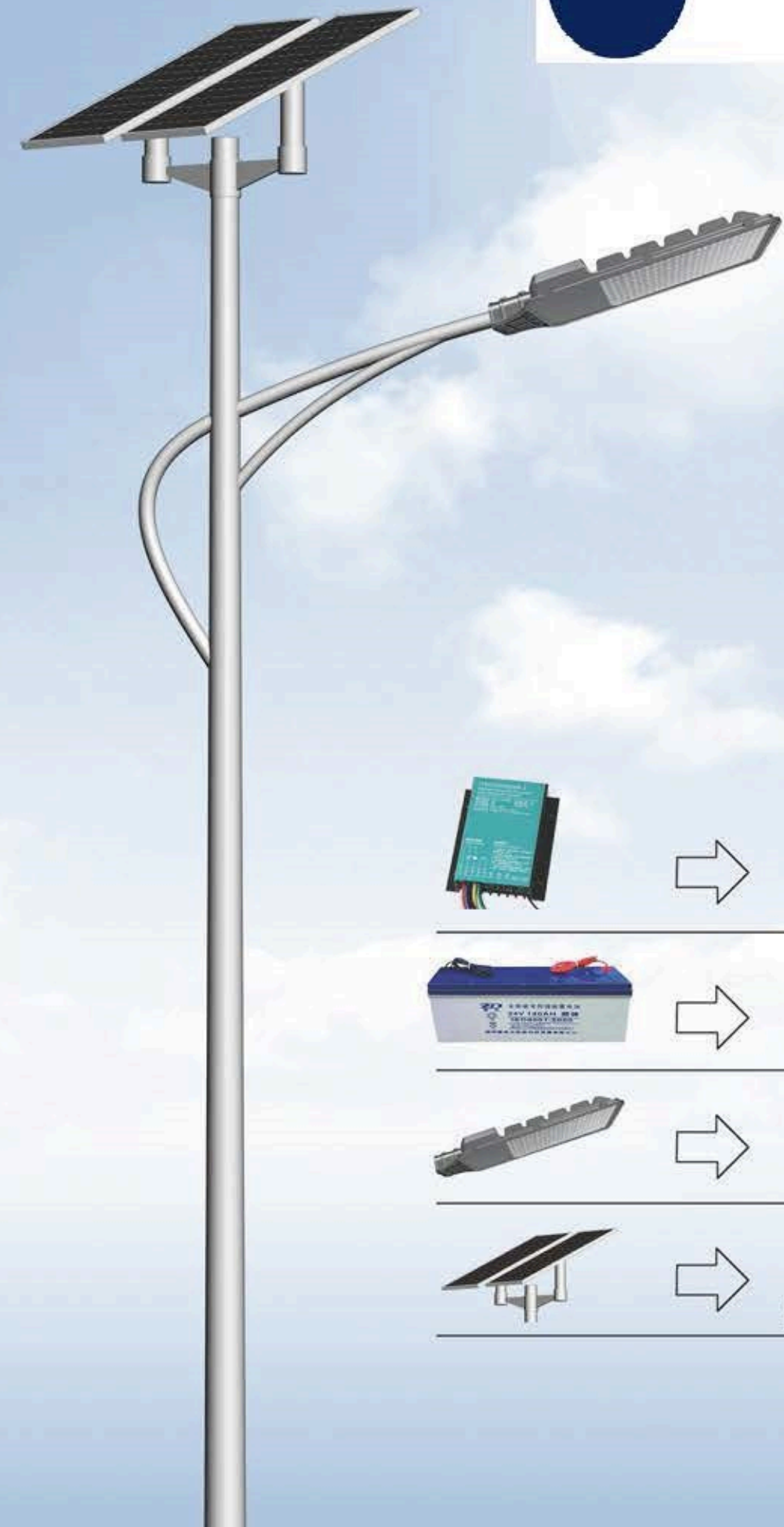
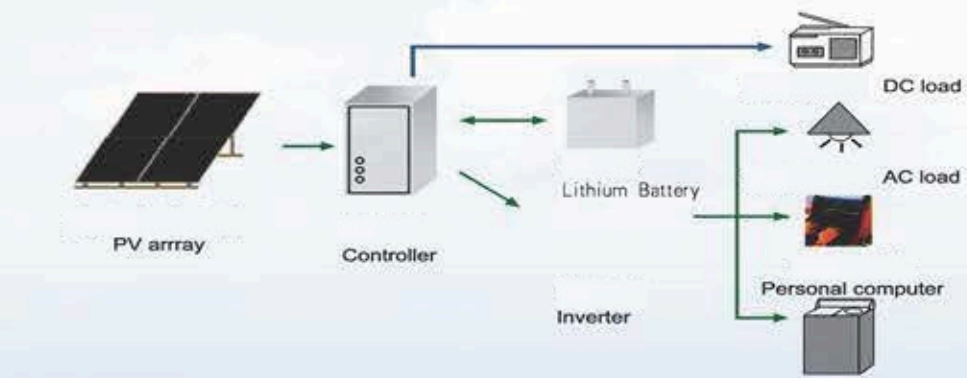
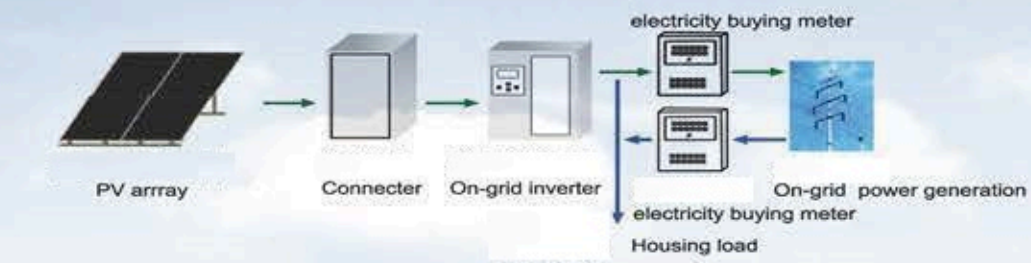

AIO SOLAR



Eastech Solar

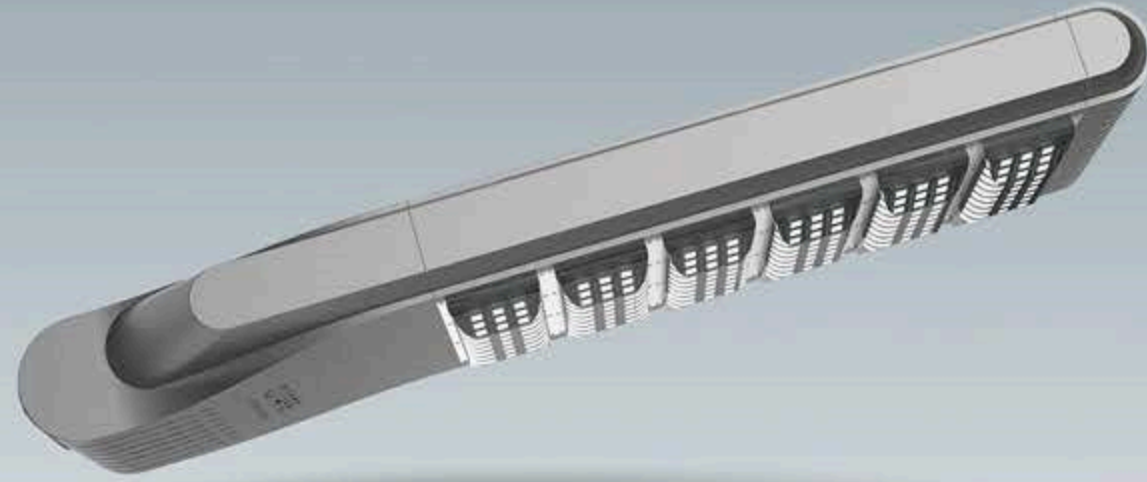

SIZE	L	H	W
A	570	100	360
B	645	100	360
C	720	100	360
D	795	100	360
E	870	100	360
F	945	100	360
G	1020	100	360
H	1095	100	360
I	1170	100	360

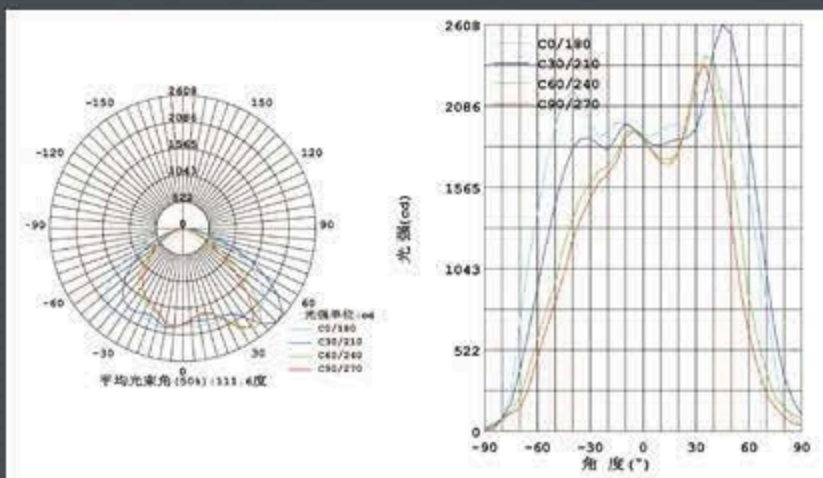

60W	90W	120W	150W	180W	210W
≥6000Lm	≥9000Lm	≥12000Lm	≥15000Lm	≥18000Lm	≥21000Lm
140"×70"	140"×70"	140"×70"	140"×70"	140"×70"	140"×70"
TK	TK	TK	TK	TK	TK
≥0.6	≥0.6	≥0.6	≥0.6	≥0.6	≥0.6
≥93%	≥93%	≥93%	≥93%	≥93%	≥93%
5500-6000K	5500-6000K	5500-6000K	5500-6000K	5500-6000K	5500-6000K
Ra≥80	Ra≥80	Ra≥80	Ra≥80	Ra≥80	Ra≥80
≤7	≤7	≤7	≤7	≤7	≤7
≤50°	≤50°	≤50°	≤50°	≤50°	≤50°
≤30°	≤30°	≤30°	≤30°	≤30°	≤30°
≥50000h	≥50000h	≥50000h	≥50000h	≥50000h	≥50000h
AC160-250V	AC160-250V	AC160-250V	AC160-250V	AC160-250V	AC160-250V
65W±1%	99W±1%	130W±1%	165W±1%	197W±1%	226W±1%
≥91%	≥91%	≥91%	≥91%	≥91%	≥91%
≥0.95	≥0.95	≥0.95	≥0.95	≥0.95	≥0.95
50-60HZ	50-60HZ	50-60HZ	50-60HZ	50-60HZ	50-60HZ
>60%	>60%	>60%	>60%	>60%	>60%
-30°-60°	-30°-60°	-30°-60°	-30°-60°	-30°-60°	-30°-60°
10%-95%Rh	10%-95%Rh	10%-95%Rh	10%-95%Rh	10%-95%Rh	10%-95%Rh
IP66	IP66	IP66	IP66	IP66	IP66
5-6m	7-8m	8-9m	9-10	11-12m	12-13m

6M 90W Solarstreetlight AIO-SST-02 Singlehead

Material characteristics

- ◆ 6-8m
- ◆ 20-60W LED
- ◆ 60-200W

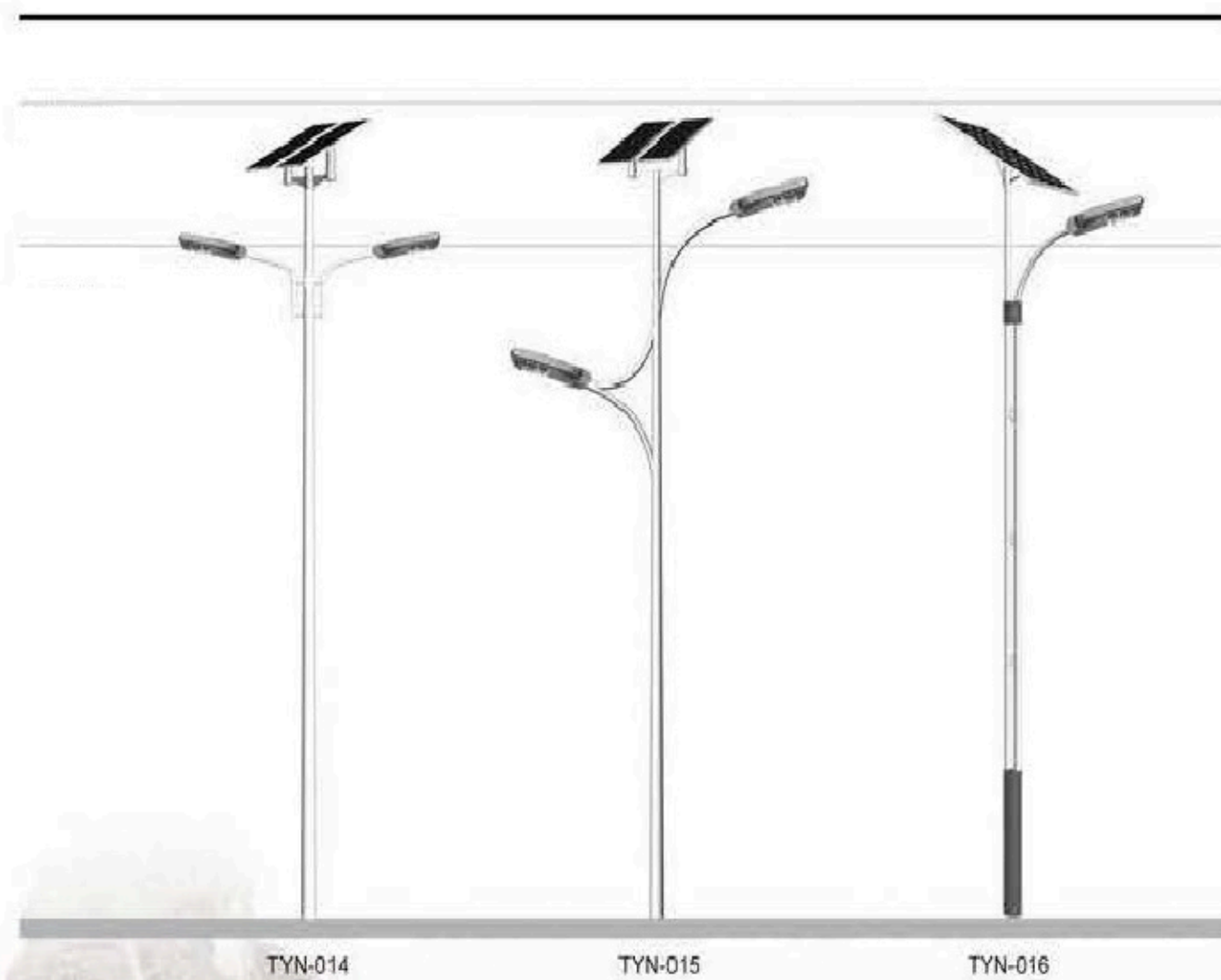

AIO-RL1037 - 90W



New generation energy saving long life & Versatile LED roadway luminaire with high power LED as light source.

Product Specifications

Housing	Die-casting aluminum housing with heat radiator
Finish	Powder coated metallic grey finish.
Light source	High efficiency globally branded LEDs with $Ra \geq 75$.
Optics	IESNA Type II Medium optics using globally branded lenses. High efficiency tempered glass cover for extra protection. COB with glass lens
Control gear	Built-in, replaceable electronic driver with APFC, $THD \leq 10\%$, Output Short Circuit Protection, Surge Voltage Protection & Over Voltage Protection.
Mounting & Maintenance	Suitable for side entry mounting with bracket arm ID of 64mm (max).
Pipe entry	Adjustable pipe entry.
Applications	<ul style="list-style-type: none"> • City road lighting • Shopping centers perimeter lighting • City light renovation/ up gradation project • Prestigious/ heritage area outdoor lighting • Car parking application

Note: Warranty Voids for LED fixtures including Drivers, if individual points of installations are not provided with proper Earthing.

Warranty: 3 Years

Technical Drawing

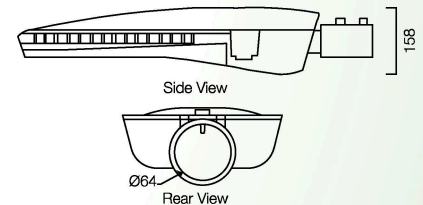

All dimensions are in mm

Technical Data

Ordering Code	System Power	Nominal Voltage (V)	Operating Temp. (Deg C)	Power Factor	Colour Temp. (CCT)	System Luminous Efficacy Lm/ W
AIO-RL 1037	90W	277	-40 - +50	≥ 0.95	5700K	≥ 95



IP66

HPF

